

# ONE UNION SQUARE

## Residence J

FLOORS PH1-PH3

1.5 Bedroom | 2 Bathroom

826 SQ FT

### Residence Features

- Crestron Smart Home\*
- Motorized Window Shades\*
- Scavolini Custom Kitchen\*
- TOTO Washlet Toilets\*
- Bosch Appliances\*
- Oversized Windows
- Expansive Views
- Heated Bathroom Floors\*
- Caesarstone Kitchen Countertops\*
- Frameless Glass Shower Door\*
- In Unit Washer Dryer\*
- Full Service Building

*\*Only in select units*

All dimensions are approximate. Plans and dimensions may contain minor variations from floor to floor. Equal housing opportunity.

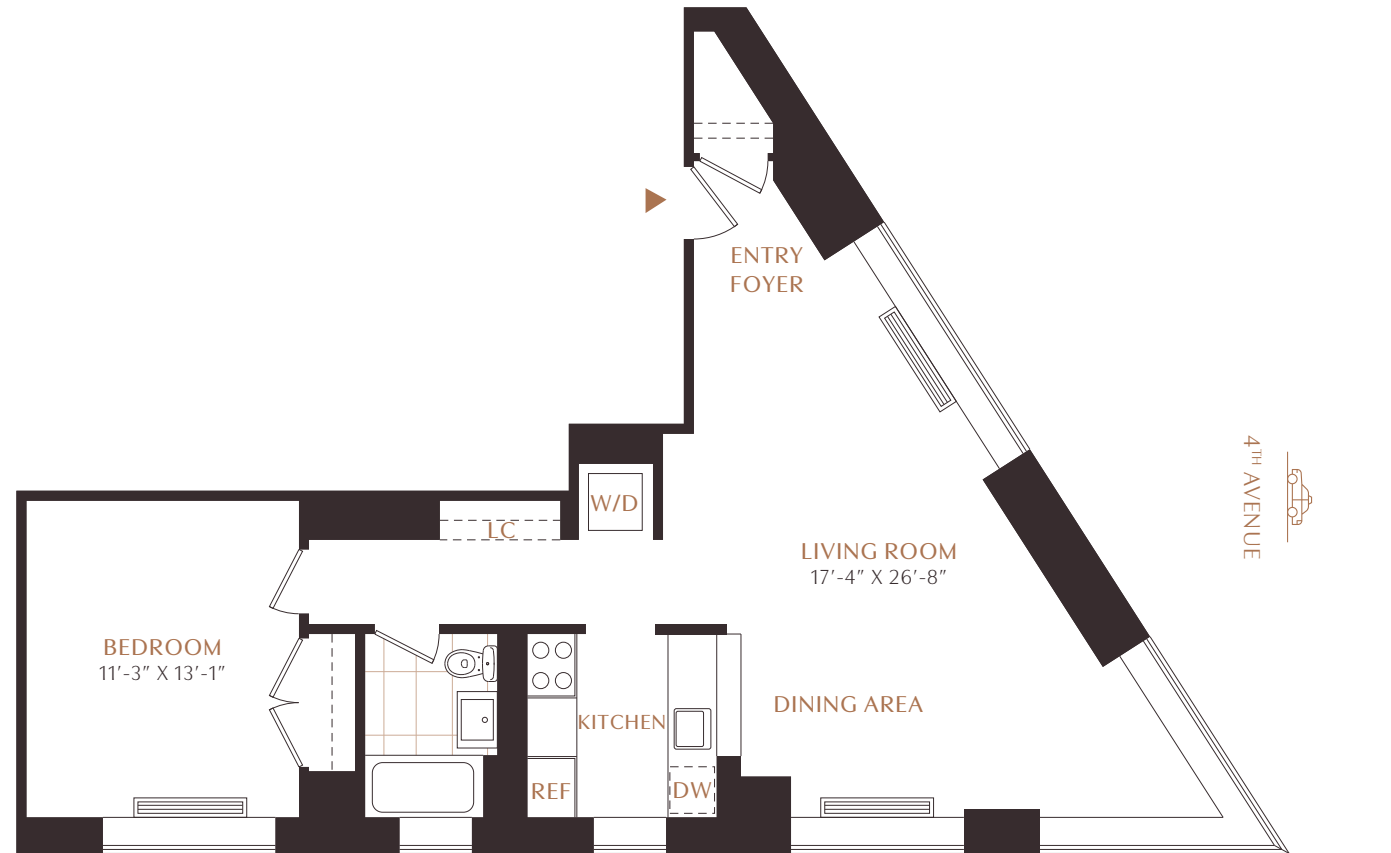

1 PARK  
VIEW

SCALE 1/8" = 1'0"

---

Residence      PH1J   PH2J   PH3J

Monthly Rent    \$

Move In            /   /

Amenity Fee     \$

---

Notes

---

Leasing Contact

---



### Level X Amenities

#### 1 PARK

- Sun Terrace
- Landscaped Great Lawn
- Grills and Entertainment Space
- Sweeping Downtown Views

#### 1 SOCIAL

- Indoor Resident Lounge
- Outdoor Event Space\*
- Conference Room
- Culinary Entertainment Kitchen

#### 1 TRAINING

- State-of-the-art Fitness Center
- Cutting Edge Outdoor Training Facility\*

### Building Features

- 24-hour Attended Lobby and Concierge
- The "Metronome", 100-ft Exterior Art Piece
- Valet Dry Cleaning
- Bike Storage\*
- Community Laundry Room
- Pet Friendly

*\*Coming Soon*