

ONE UNION SQUARE

Residence F

FLOORS PH1-PH3

1 Bedroom | 1 Bathroom

612 SQ FT

Residence Features

- Crestron Smart Home*
- Motorized Window Shades*
- Scavolini Custom Kitchen*
- TOTO Washlet Toilets*
- Bosch Appliances*
- Oversized Windows
- Expansive Views
- Heated Bathroom Floors*
- Caesarstone Kitchen Countertops*
- Frameless Glass Shower Door*
- In Unit Washer Dryer*
- Full Service Building

*Only in select units

All dimensions are approximate. Plans and dimensions may contain minor variations from floor to floor. Equal housing opportunity.

UNION SQUARE PARK VIEW

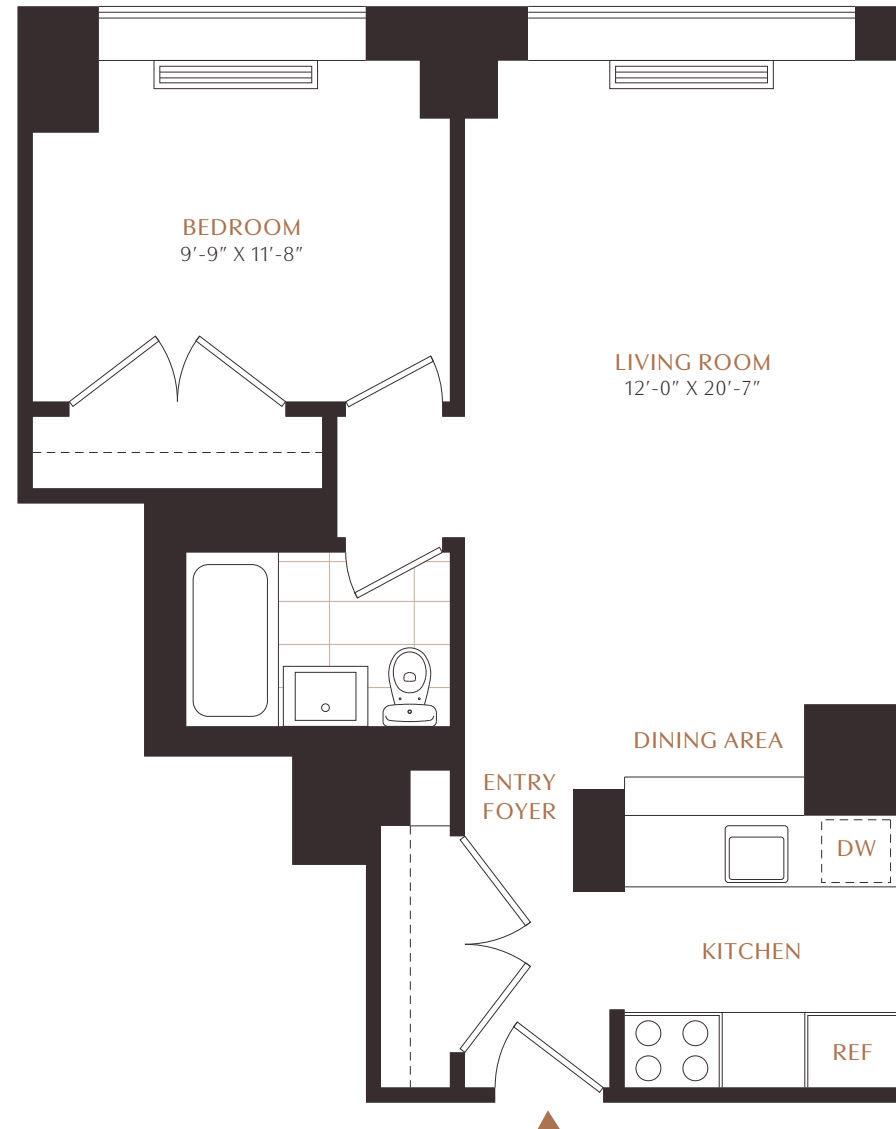
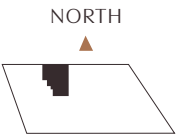

SCALE 3/16" = 1'0"

Residence PH1F PH2F PH3F

Monthly Rent \$

Move In / /

Amenity Fee \$

Notes

Leasing Contact



Level X Amenities

1 PARK

- Sun Terrace
- Landscaped Great Lawn
- Grills and Entertainment Space
- Sweeping Downtown Views

1 SOCIAL

- Indoor Resident Lounge
- Outdoor Event Space*
- Conference Room
- Culinary Entertainment Kitchen

1 TRAINING

- State-of-the-art Fitness Center
- Cutting Edge Outdoor Training Facility*

Building Features

- 24-hour Attended Lobby and Concierge
- The "Metronome", 100-ft Exterior Art Piece
- Valet Dry Cleaning
- Bike Storage*
- Community Laundry Room
- Pet Friendly

**Coming Soon*