



BUILDING AMENITIES

- › Elegant Porte Cochère Entrance Drive
- › 24-Hour Concierge-Attended Lobby Appointed in Imported Woods and Marble with Glass Loggias plus Oval Wood and Marble Elevator Vestibule
- › State-of-the-Art Health and Fitness Center with Cybex, Stairmaster, Quinton and Cardio Theatre with Yoga Room**
- › Skylit Indoor Pool with Adjacent Sun Deck**
- › Lushly Landscaped Private Garden
- › RelatedStyle Services™ including Personal Assistant Services, Convenient Credit Card Rent Payment, and Move-In Coordination***
- › Valet Garage Parking Onsite**
- › Interactive Children's Play and Party Room**
- › Professionally Designed Business Center with Fax, Copier, and Internet Access**
- › Storage Space**
- › Bicycle Room**
- › Valet Services**
- › Laundry Room on Every Floor
- › Convenient ATM in Lobby
- › Professional On-Site Leasing & Management Service Centers

APARTMENT FEATURES

- › Floor-to-Ceiling Windows*
- › Terraced Apartments*
- › Gourmet Kitchens with Granite Counters, Microwaves, Self-Cleaning Ovens, Ice Maker/Frost-Free Refrigerators, Dishwashers and Ceramic Tile Floors
- › Contemporary Bathrooms with Marble Walls and Floors, Pedestal Sinks and Custom Designed Medicine Storage Cabinets with Tri-View Mirrors
- › Granite Window Sills and Designer Mini-Blinds
- › Windowed Kitchens*
- › Walk-In Closets* and Customized Closets
- › Oak Parquet Floors in Living Room, Dining Room, and Foyers
- › Wall-to-Wall Carpeted Bedrooms
- › Individual Intrusion Alarms
- › Individually-Controlled Heating and Air Conditioning
- › Prewiring for Multiple Phone Lines and High Speed Internet Access

* In Select Residences **Additional Charge ***Additional Charge for Some Services

MANAGEMENT & LEASING CENTER

- › (212) 945-4100 fax (212) 945-4101
tribecaparkleasing@related.com
www.tribecapark.com

EQUAL HOUSING OPPORTUNITY

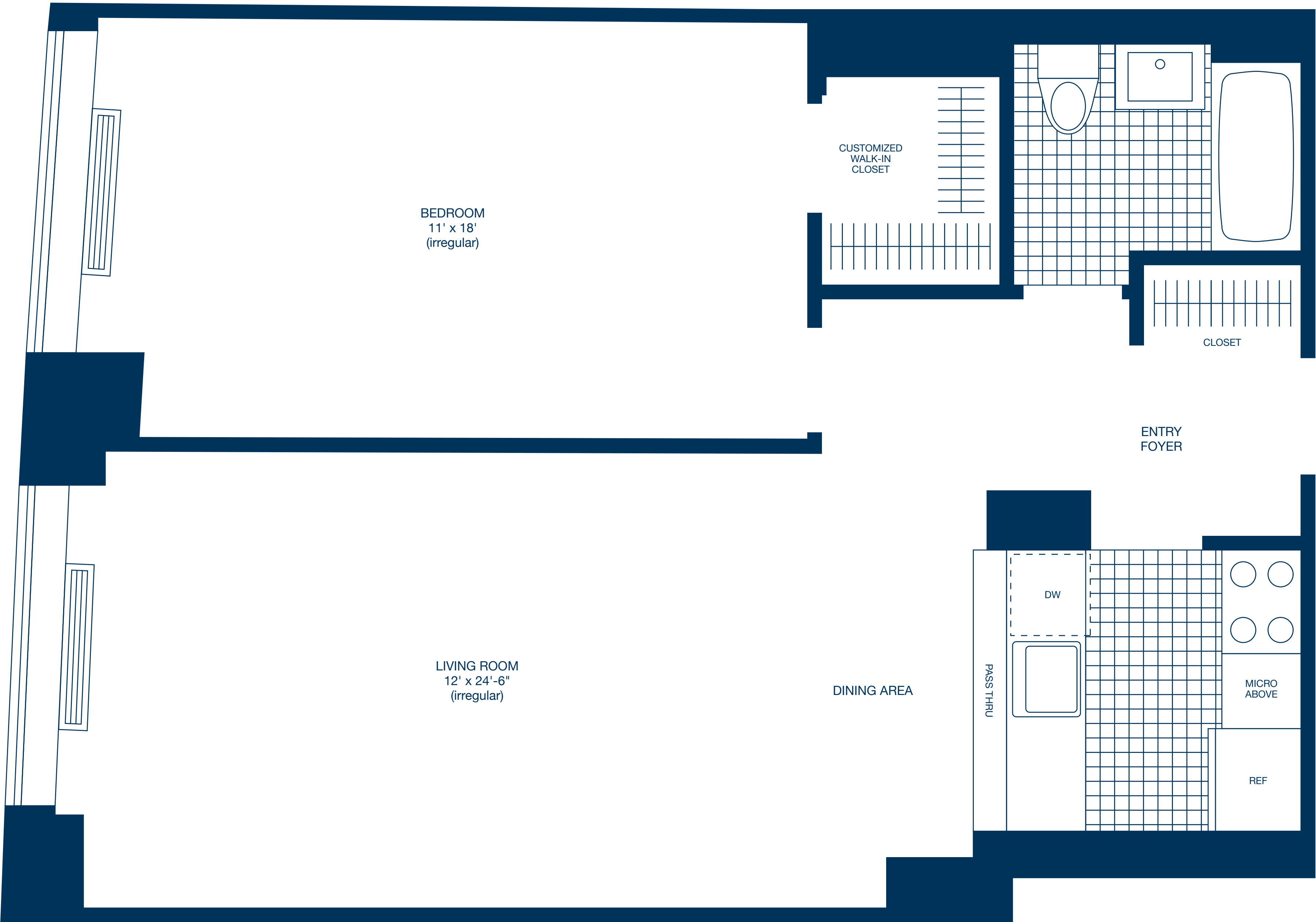

One-Bedroom
Plus Dining
Area

Residence F
Floors 3-4

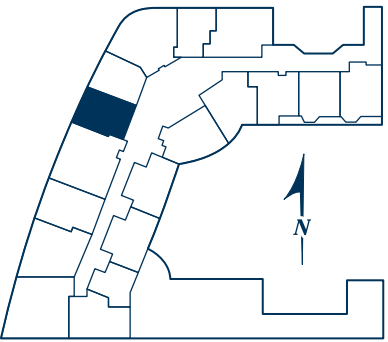

FLOOR
MONTHLY RENT

All Dimensions Are Approximate